

Proceed as follows:

- Change the backup battery with the power switch in the ON position!
- Open the front door of the CPU.
- Pull the backup battery out of the compartment with a screwdriver.
- Plug the connector of the new backup battery into the corresponding socket in the battery compartment of the CPU.
- Place the backup battery into the battery compartment on the CPU.
- Close the front door of the CPU.

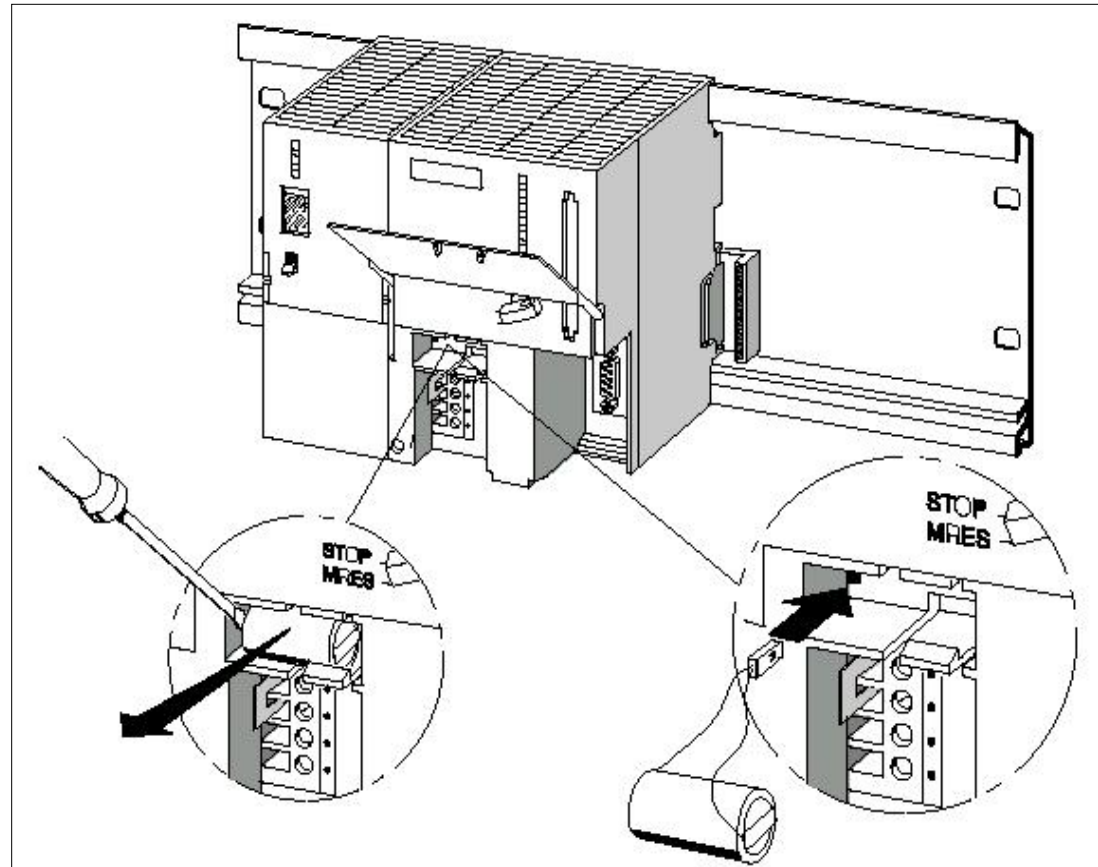

Fig. 3.1 : Changing the backup battery